

INDIANA WESLEYAN
UNIVERSITY



2025 President's Report

FROM THE DESK OF JON S. KULAGA, PHD



ON MISSION. IN MOTION.

FROM THE DESK OF THE PRESIDENT



God is creating new pathways through IWU, forming Christ-centered world changers for His Kingdom.

JON S. KULAGA
IWU President

At Indiana Wesleyan University (IWU), we are living in a season of renewal. Across our campuses and programs, we see God doing a new thing, creating pathways where there once seemed to be barriers and refreshing our mission with strength and clarity. Isaiah’s words capture this beautifully: “For I am about to do something new. See, I have already begun! Do you not see it? I will make a pathway through the wilderness. I will create rivers in the dry wasteland” (Isaiah 43:19).

These words remind us that God is always at work, renewing, restoring, and reshaping us for His purposes. Over the past year, we have seen His hand guiding IWU through both challenges and opportunities, and we rejoice in the new pathways He is creating before us.

We remain steadfast in our Kingdom mission: to form Christ-centered world changers who bring hope and healing to a world in need. At the same time, we are boldly advancing strategic initiatives that expand innovative academic programs, deepen strategic partnerships, and strengthen IWU’s financial health. Together, these efforts are positioning IWU for greater impact locally, nationally, and globally. Yet behind every number and every initiative are our people. Students are discovering their calling. Faculty are mentoring with wisdom. Staff are serving with excellence. Partners are opening new doors, investing in us, and supporting us through prayer. It is through these people, empowered by God’s Spirit, that rivers of blessing continue to flow and the world is changed.

I invite you to read this year’s President’s Report with thanksgiving and expectation. Celebrate with us what God has done and join us in anticipating what He will yet do through the mission of IWU for the honor of Christ and the advancement of His Kingdom.

Jon S. Kulaga Ph.D.
IWU President



On Mission In Motion

IWU is unwavering in its mission: to be a Christ-centered academic community committed to changing the world by developing students in character, scholarship, and leadership. That mission grounds every program we create, every partnership we pursue, and every student we serve. Being **ON MISSION** means that our foundation does not shift with trends or cultural pressures. For more than a century, IWU has held fast to this calling, preparing graduates who live and lead with integrity, courage, and a Kingdom perspective. This commitment unites the IWU community, a community of students preparing to serve, alumni influencing the world, and partners who invest in our mission.

But we are also **IN MOTION**. Our mission does not call us to stand still. Instead, we are compelled to innovate, to pioneer new models of learning, and to expand opportunities that serve learners of every age and stage of life. From our residential campus in Marion, Indiana, and Wesley Seminary to online and regional programs serving students across the U.S. and around the world, to emerging initiatives in AI and the skilled trades, IWU continues to move forward in ways that are bold, faithful, and future-focused. Students are finding faster, more affordable ways to graduation, including stackable credentials that shave months off a degree and our newly launched, innovative 90-credit bachelor's degrees.

Ultimately, being on mission and in constant motion means we are equipping graduates who carry Christ's light into every field of influence, including business, ministry, healthcare, education, technology, the arts, and beyond. This is what makes IWU not just a university, but an academic community committed to forming world changers who advance God's Kingdom in their everyday lives.

LEADING IN A SHIFTING LANDSCAPE

Across the U.S., higher education is facing profound disruption. Declining demographics, financial strain and shifting cultural expectations have led to closures, mergers and uncertainty. Families rightly ask if higher education remains worth the cost and sacrifice. IWU is answering that question with a resounding yes. By holding fast to our Christ-centered mission while leaning boldly into innovation, we are not only surviving in turbulent times but also thriving.

IWU is already building the future. By God's blessing, we remain a university on mission and in motion.

15k **51**
Students Countries
12.8% Increase
Since 2023

+30%
Year Over Year
Net Operating Results





Vision & Momentum Plan

“

For I am about to
do something new.
See, I have already
begun! Do you not see it?
I will make a pathway
through the wilderness.
I will create rivers
in the dry wasteland.

ISAIAH 43:19

Vision gives us direction, and momentum carries us forward. IWU's vision is to be the Christ-centered institution of choice for every generation, which means we must equip our students to bring hope, healing, and leadership into every sphere of society.

The Momentum Plan is our strategic plan roadmap guiding us toward our vision. It centers on **FIVE PRIORITIES** that keep us faithful to our calling: **ENROLLMENT, TECHNOLOGY, HOSPITALITY, ASSESSMENT, AND STEWARDSHIP**. Through these priorities, every step we take is rooted in Christ and directed toward forming world changers who bring hope and healing into the world. As we follow God's leading, momentum is building. New pathways, partnerships, and programs are already turning vision into reality. With bold faith and steady resolve, IWU is moving confidently into the future God has called us to, on mission and in motion.

MOMENTUM PLAN PRIORITIES

1. ENROLLMENT

We will accelerate enrollment growth to be a university of 20,000.



2. TECHNOLOGY

We will build technology infrastructures that support our institutional growth.



3. HOSPITALITY

We will cultivate an organizational culture of hospitality and employee care through worth, welcome, warmth, wellness, and witness.



4. ASSESMENT

We will develop assessment practices that ensure alignment and continuous improvement across our institution.



5. STEWARDSHIP

We will fuel our mission through generous giving and faithful stewardship of the resources God has entrusted to us.





EDUCATIONAL INNOVATION



Faith does not fit neatly into any one discipline or experience. It permeates all of life, calling forward what it means to be disciples of Jesus Christ. The Center for Faith & Learning serves as a bridge for faith between academic disciplines and students' lives.

TODD REAM

University Professor and Executive Director of Faculty Scholarship

CENTER FOR FAITH AND LEARNING: INVESTING IN THE VIBRANCY OF OUR MISSION

At the heart of IWU is the synergistic relationship of faith and learning, which attracts faculty and students who desire to put faith into practice in their careers and lives. Last January, IWU began the journey to establish a new initiative, the Center for Faith and Learning, a hub that equips faculty to integrate faith into their teaching, service and research through training programs, mentoring and practical resources. Just eight months later, in August, the Center launched opportunities and resources to equip new faculty in innovative and transformative approaches to classroom instruction, scholarship and service. Ongoing mentoring helps existing faculty weave faith more deeply into every dimension of their work. The center also strengthens faculty in research, scholarship and publishing, cultivating the integration of moral and intellectual virtues in teaching and service.



CENTER FOR
**Faith &
Learning**



DID YOU KNOW?

IWU is one of the largest members of the Council for Christian Colleges and Universities (CCCCU), the largest private college in Indiana by enrollment.

NEW ACCELERATED 90-CREDIT DEGREES DELIVER FAST-TRACK TO CAREERS

IWU's four-decade history of rethinking traditional university experience has taken a giant leap forward in making higher education more accessible and affordable. In August, IWU's accreditor, the Higher Learning Commission, approved IWU's first 90-credit bachelor's in education, making the university one of the first in the Midwest to offer this accelerated degree. This is just the beginning. Over the next year, the university plans to launch additional online accelerated bachelor's degrees in high-demand fields such as applied AI analytics, AI marketing, psychology and human services, and criminal justice. The motivation is simple: reducing credit requirements by 25 percent lowers tuition, maintains rigorous quality, and accelerates time to degree and job market entry.



We are constantly exploring new ways to make higher education more accessible. With the new 90-credit bachelor's degrees, we continue our longstanding commitment to pioneering solutions that help all students succeed in their careers and communities.

EILEEN HULME

Chancellor



AT A GLANCE

from 2022-2024



Publication of our textbook, “Essentials of Followership: Rethinking the Leadership Paradigm with Purpose” in 2022 has created a standing in the field whereby IWU now has global recognition as one of the thought leaders in followership.

MARK RENNAKER

Chair, Division of Leadership and Followership Studies
Devoe School of Business, Leadership and Technology

\$51.1M

in research grants and
external funding

400+

undergraduates
involved in research

300+

faculty articles
published

36

books authored
by faculty

260+

principal investigators
participated in reasearch

Research

DEEP IN THE HEART OF TEXAS WITH A GROWING TEACHERS INITIATIVE

People like to say things are bigger in Texas. A new example is the teacher shortage that has emerged as large numbers of people relocate to the Lone Star State, leaving school districts under-resourced. School districts in Texas turned to IWU for an innovative approach to preparing, credentialing and hiring teachers. IWU launched the Texas Teachers Initiative to supply districts with high-quality educators trained in a Christ-honoring, faith-based program and prepared to excel inside and outside the classroom. School districts benefit from partnering with an accredited university that offers flexible pathways to teaching degrees and licensure. The initiative supports IWU's mission of emphasizing character, scholarship, and leadership. The impact has been, well, BIG. One partner district has filled more than 80 teacher openings through the program. Plans call for expansion to 1,000 Texas school districts by 2027 and into two additional states. This initiative has also sparked other academic opportunities, as IWU-Texas continues to expand with new degrees and programs.

ENGAGING STUDENTS IN RESEARCH INSPIRES A LIFETIME OF CURIOSITY AND ACHIEVEMENT

At IWU, research is not merely an academic exercise or a financially motivated endeavor. It is an act of worship. Each project and discovery that emerges from our research is a faithful response to the Creator who calls us to seek truth, cultivate wisdom and steward the world with excellence. A defining feature of IWU's research is its emphasis on student engagement as a transformative learning experience that can inspire a lifetime of world-changing inquiry.

The Hodson Research Institute, established in 2011, empowers students to explore big questions, solve real-world problems and grow through hands-on, faculty-mentored projects. Its summer program is a full-time, eight-week immersion that acquaints students with every phase of the research process. It is where curiosity meets calling and where students discover how their passions can make a lasting impact. Alumnus Ethan Naylor '12 participated in the institute's inaugural year. He is now a biomedical engineer at the U.S. Food and Drug Administration (FDA) and one of many former students who have gone on to serve through research.



We believe this initiative shows what happens when innovation meets mission. We are preparing excellent teachers for Texas schools today while building a vision that reaches far beyond the state.

EILEEN HULME
Chancellor

&

Expansion

HODSON RESEARCH INSTITUTE

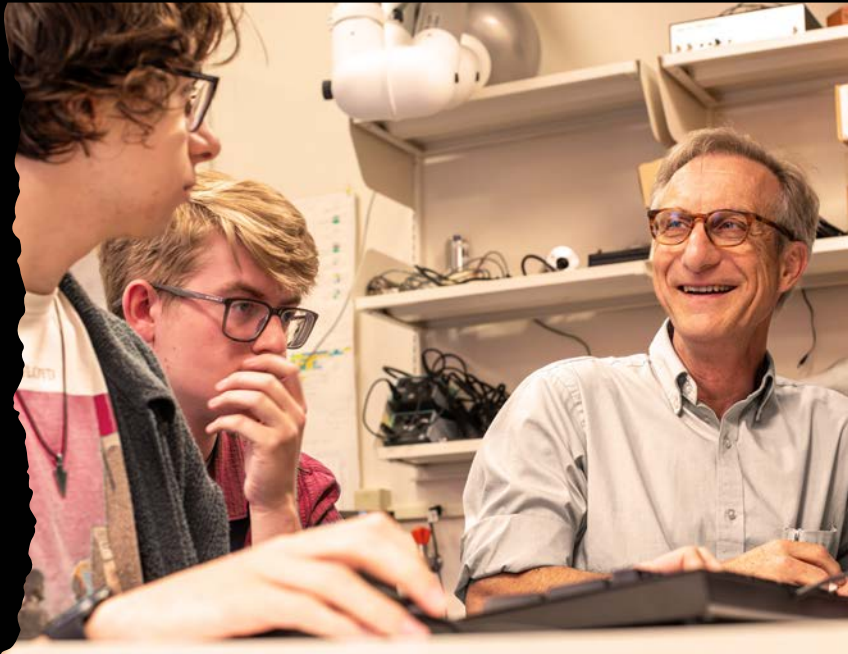



GLOBAL REACH, INTERNATIONAL EDUCATION

Wesley Seminary at IWU is igniting a worldwide movement of pastoral and church leadership. In Africa, Asia, Latin America, and Europe, pastors who once lacked access to formal training are now deepening their biblical knowledge and leadership skills without leaving their communities. Through innovative hubs, like the Lantern project and online learning, leaders remain rooted in their congregations while receiving a Christ-centered education that multiplies their impact.

These pastors are not only strengthened for their own ministries but equipped to disciple others, creating ripple effects that reach far beyond a single classroom or church. Each course and each mentoring relationship fuels movements of churches that are thriving in their calling to spread the Gospel. By extending theological education across continents, Wesley Seminary is living out IWU's Kingdom vision and forming world changers who advance Christ's mission wherever God has placed them.

Wesley Seminary is equipping leaders across the world to bring the light of Christ into their communities, keeping Him at the center of all they do.



21ST CENTURY CHURCH INITIATIVE

The challenges facing today's pastors are profound, yet Wesley Seminary is shining a light on solutions that keep Christ at the center. The 21st Century Church Initiative, anchored by The Lantern, offers a global hub where pastors find community, encouragement, and practical tools online that point them back to the hope of the Gospel.

Through resources, shared networks, and mentoring, pastors gain fresh vision for ministry in areas such as mental health, youth discipleship, and mission entrepreneurship. What might feel overwhelming alone becomes possible together. The Lantern reflects IWU's heart for the church by equipping leaders to flourish in their calling while keeping Christ as the foundation of every effort.



The Lantern is helping us create an ecosystem where theology and practical ministry come together—and where leaders grow through shared learning, relationships, and real community.

YAMIL ACEVEDO
Executive Vice President
Wesley Seminary



IWU EXPANDS COLLABORATION WITH MOTB WORLD STAGE THEATER



museum of the Bible



In spring 2024, IWU became the exclusive academic sponsor of the Museum of the Bible's (MOTB) World Stage Theater, launching a formal partnership to bring campus scholarship and artistry to national audiences. This year IWU deepened that partnership through a series of collaborations that showcased student talent and faculty scholarship. From Dec. 19–21, 2024, the 40-member IWU Chorale performed traditional lessons and carols at the museum's candlelight concert series, accompanied by local musicians, an orchestra, and professional performers Anthony Evans and Tasha Layton from the Gospel Music Association.

In April, faculty members Steve Wood and Amy Smelser filmed short talks at the museum to create accessible educational content that connects Scripture with contemporary culture. Wood traced the Bible's influence on popular culture and the arts, and Smelser reflected on C.S. Lewis, imagination, and how story points to truth. Both videos were released on IWU's social media and YouTube channels, with additional faculty talks planned to roll out over the next year. Together these activities extend IWU's reach to wider audiences and invite the public to engage Christianity in culturally resonant ways. The partnership has also provided IWU with a pipeline of prospective students from the East Coast.



Our partnership with the Museum of the Bible and the World Stage Theater continues to open doors for our students, faculty, and alumni. From music that stirs the soul to teaching that connects Scripture with contemporary life, this collaboration is advancing our shared mission of lifting high the Word of God and shaping culture with Christ at the center.

JON S. KULAGA
IWU President

COMMUNITY COLLABORATION GIVES KIDS AND PARENTS A MUCH-NEEDED BOOST

Grant County, Indiana families and IWU employees celebrated the August opening of a much-needed resource, a state-of-the-art childcare center. Located near IWU's campus, the Westminster Wildcats Early Learning Academy is a partnership between IWU and Westminster Preschools, made possible by a \$547,000 grant from the Lilly Endowment. The center is a key project of the university's Momentum Plan and reflects IWU's commitment to meeting urgent community needs with Christ-centered excellence. "High-quality, accessible childcare is essential for families in Grant County, and this partnership allows us to extend care and hospitality in a meaningful way," said Jon Kulaga, president of IWU. The center also offers IWU students practical, real-world experience in early childhood education, helping them grow as Christ-centered leaders for children and families. The center focuses on whole-child wellbeing and uses Westminster's Well-being Curriculum to integrate Christian values, academics, and social-emotional development.



“

Westminster is setting kids up for lifelong success—not just academically, but socially and emotionally. Children learn they're loved and safe, and that learning is fun. These social skills and relationships will carry with them through their entire academic career.

DANI SVANTNER

Executive Director of Westminster Preschools and an IWU alumna





People & Culture



BUILDING A CULTURE OF ORGANIZATIONAL HOSPITALITY

Treat someone with kindness and watch the ripple effect unfold. Even the smallest acts of care can have a profound impact. At IWU, this conviction has grown into a campus-wide movement called High-Impact Hospitality, a vision inspired by hundreds of voices across our community and rooted in Christ's call to love others.

High-Impact Hospitality is built on five guiding values: Worth, Welcome, Warmth, Wellness, and Witness. Together, they set a new standard for how we honor every person who steps onto our campus or engages online, including students, employees, alumni, families, partners, and guests. For students, it means a culture where they feel deeply known and supported. For faculty and staff, it means a workplace marked by kindness, authenticity, and shared mission. For the broader community, it is a visible sign of Christ at work through us.

Practical steps are already in motion. Professional development programs and intentional mentoring are equipping employees to embody hospitality in everyday interactions. Through these efforts, IWU is creating not a moment of hospitality but a lasting culture that reflects Christ's heart in every interaction.



WELCOME CENTER: A FIRST STOP OF HOSPITALITY

This winter, IWU will open its first-ever Welcome Center at the southwestern entrance to its main Marion, Indiana campus. The project is a bold step that will make hospitality visible the moment a guest arrives on the Marion campus.

Renovation is underway, with a December 2025 completion and a ribbon-cutting in January 2026. Designed as the first stop for prospective students, families, and visitors, the Welcome Center will streamline the campus visit experience by housing representatives from Admissions, Financial Aid, and the Registrar's Office. It will also include interactive maps, gathering spaces, and a coffee bar to create a warm, personal first impression.

The facility will also host a rotating collection of biblical artifacts through IWU's partnership with the Museum of the Bible in Washington, D.C. This collaboration will enrich each visit with a meaningful reminder of the university's Christ-centered mission and heritage.

The Welcome Center stands as a visible expression of IWU's commitment to High-Impact Hospitality, a campuswide practice of delivering consistent warmth, excellent service, and thoughtful attention to every visitor at every interaction. The space will welcome thousands each year with kindness, excellence, and the love of Christ.



“
High-Impact Hospitality is about seeing people the way Christ sees them, loving them the way Christ loves them, and reminding every person who comes to and through IWU that they truly matter, belong, have earthly and eternal worth, and are known.

KAREN DOWLING
 Executive Vice President
 Chief People and
 Culture Officer

The Power of Our Values

At IWU, our values shape who we are and how we live together. Humility, belonging, integrity, courage, innovation, agility and kindness are essential to how we learn, lead and serve in Christ's name. Each value informs the daily rhythm of campus life and prepares our graduates to carry Christ's light into every sphere of society.

This year we placed these values on walls across our main Marion, Indiana campus so students, faculty, staff and visitors see them every day and are reminded that our culture is built on Christ-centered character. Plans are under way to expand these visual expressions into additional spaces and regional centers so our community continues to be formed by them. Together, these values keep us rooted in God's truth and united in the mission of forming world changers.



KINDNESS

We value loving others through generous hospitality, compassion, and respect.

Luke 7:11-17



HUMILITY

We value putting others first and having the attitude of Christ.

Philippians 2:5



BELONGING

We value community that honors our God-given differences.

John 13:34-35



INTEGRITY

We value being consistently ethical, honest, and trustworthy.

Matthew 5:8



COURAGE

We value acting on conviction, even in the face of fear.

Matthew 14:22-33



INNOVATION

We value creative solutions that help solve real-world problems.

Romans 12:2



AGILITY

We value systems thinking and the ability to adapt to current realities.

Matthew 10:16





I AM THIRD

NEW ARENA REPRESENTS A COUNTERCULTURE SHIFT BACK TO CHRIST

With one year until IWU's I AM THIRD Arena opens in fall 2026, excitement about its potential impact is palpable. The arena will welcome athletes, coaches, students and the community, with a capacity of more than 2,000 fans, five premium suites and the NAIA's premier basketball-only facility.

The facility will be more than a conventional sports venue. The Arena is designed as a ministry platform that puts God first, others second, and self third. IWU's basketball program, led by Coach Greg Tonagel, has adopted this philosophy to raise awareness of the program and the university on and off the court. An important part of the vision is equipping youth and college and professional coaches to apply this transformative ethos in their own programs. Regular team chapels and community youth coaching clinics will make the arena a training ground for Christ-centered leadership.

Momentum is already building. As of mid-September, IWU had received nearly \$25 million in pledges toward the \$30 million cost. Each gift supports a vision that will shape generations for Christ.

80K
SQUARE FEET

2,000+
CAPACITY

5
SUITES

**NAIA'S
BEST**
PREMIER BASKETBALL
FACILITY

**The I AM THIRD Arena will
inspire generations to trade self
for Christ-centered service**

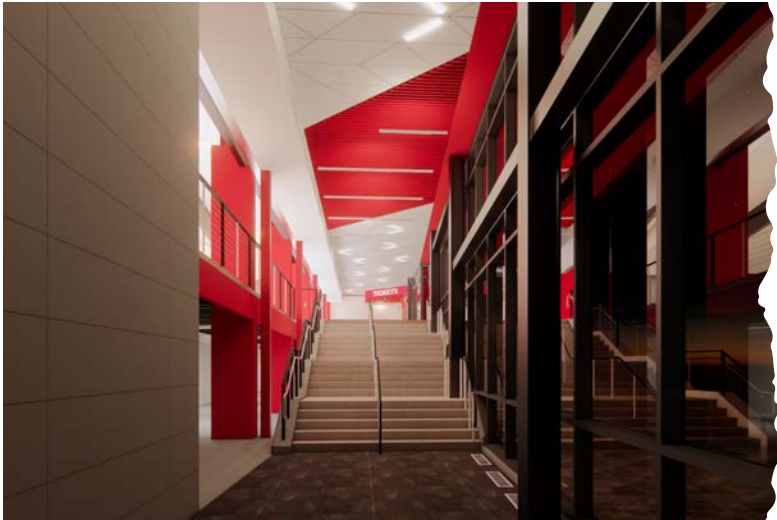

WILDCAT ATHLETICS

26 NAIA
NATIONAL
CHAMPS

677 NAIA
ALL-AMERICANS

29 NCCAA
NATIONAL
CHAMPS

27 CROSSROADS LEAGUE
ALL-SPORTS TROPHIES

295 CROSSROADS LEAGUE
CHAMPIONSHIPS

Summer Ministries

EXAMEN

Examen is a one- or two-week summer academy at IWU that invites high school students to explore a call to vocational ministry.

24 STUDENTS

3 CREDITS EACH

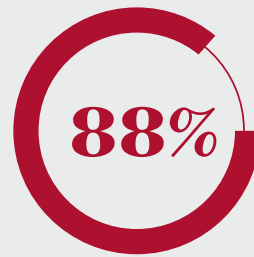

OF EXAMEN STUDENTS COMMIT TO IWU

\$50K

ONE-TIME LILLY AWARDED GRANT FOR THE SUSTAINABILITY OF THE EXAMEN PROGRAM

August 2025-December 2026

STUDENT MINISTRIES

6 MINISTRY TEAMS

12 STATES VISITED, INCLUDING CANADA

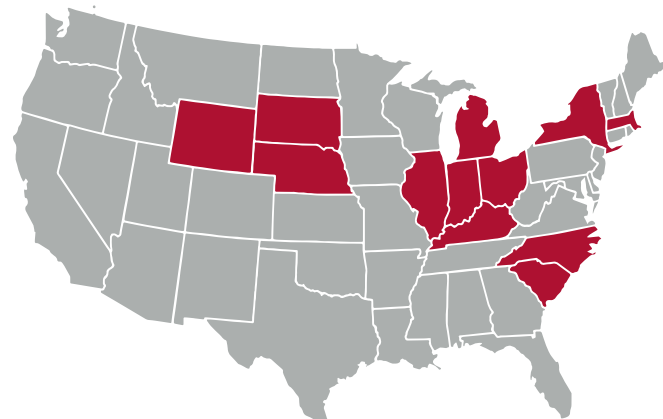

15K

STUDENTS REACHED

38

CAMPS VISITED

Wildcat Summer Academy

133 STUDENTS REGISTERED FOR CAMPS

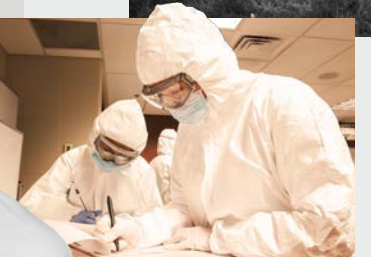

94%

OF CAMPERS REPORTED INCREASE IN KNOWLEDGE OF CAMP SUBJECT

9 CAMPS OFFERED

- FORENSIC SCIENCE
- ART+DESIGN
- COMPUTER SCIENCE
- ENGINEERING
- MUSIC THERAPY
- NURSING
- HARVEST COOKING
- STORYLAB
- SOCIAL WORK

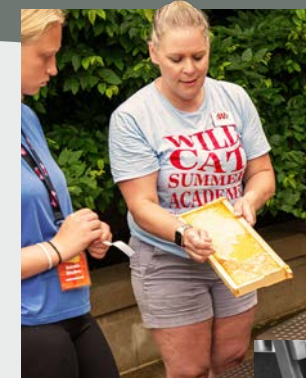

56% OF SENIORS WHO ATTENDED WSA ENROLLED AT IWU



Financial Stewardship & Enrollment

IWU is celebrating another strong financial year that reflects both stability and careful stewardship. Stable in-person and online enrollment, strong investment performance and prudent expense controls produced the best financial results in the university's history, with net operating results improving 30% year over year. This financial strength enables IWU to serve students with excellence, expand opportunities and continue preparing Christ-centered leaders for the world. It also positions the university to make strategic investments that fuel growth and innovation during unprecedented times in higher education.

Revenue highlights include stronger net tuition and increased earnings on operating cash. Expense highlights include stable employee benefit costs and successful contract renegotiations.

Cost-saving measures produced meaningful savings through renegotiated contracts, program adjustments, subscription and licensing reductions, health-care changes, improved banking terms and other targeted operational efficiencies, all while making strategic salary increases to invest in our people.

The endowment also had a strong year. For the 12-month period ended June 30, 2025, investment returns exceeded 12%, bringing the endowment balance to \$309.91 million.

Our positive financial situation allows the university to make strategic investments to continue to grow the university during unprecedented times in higher ed.

“

This year's financial results are a testimony to God's provision and the faithful stewardship and diligent work of our entire community. Because of this strength, we are able to serve students with excellence today and position IWU for growth that will positively impact generations to come.

JEFF RAYIS
Chief Finance Officer



4 SIGNS OF A HEALTHY UNIVERSITY

1. THE REVENUE FROM VARIOUS SOURCES IS GREATER THAN THE USE OF THAT FUNDING

105%

Improvement
year over year

	FY 2024	FY 2025
Sources	\$216,396,000	\$257,407,000
Uses	\$182,143,000	\$187,111,000
Sources Less Uses	\$34,253,000	\$70,295,608

\$70,295,608

Increase in net assets

3. HAVING SUFFICIENT LIQUIDITY WITH UNRESTRICTED CASH ON HAND TO OPERATE

Unrestricted days
cash on hand

3 DAYS
FY 2023

44 DAYS
FY 2024

46 DAYS
FY 2025

5%

Net tuition growth

2. WORK TOWARD A 50% MARGIN OF EMPLOYEE COMPENSATIONS & BENEFITS TO TUITION

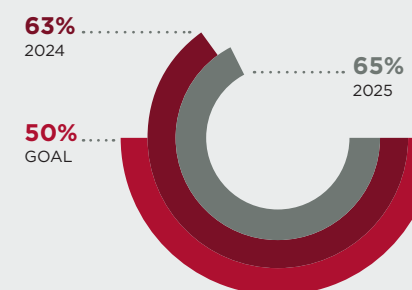

FY25 Margin increased slightly to implement market-based compensation increases

4. THE INVESTMENT PERFORMANCE OF THE ENDOWMENT IS A KEY DRIVER OF SCHOLARSHIPS AND OTHER STUDENT FUNDING

\$21.28M

Increase in endowment
year over year



12%

Full year endowment
investment performance

12,146

Total IWU National & Global Enrollment
August 2025

2,140

Total Graduate and Undergraduate IWU-Marion Enrollment
August 2025

714

Total Wesley Seminary Enrollment
August 2025

15,000

Total IWU Enrollment All Units
August 2025

\$309M

Endowments
Largest in Institutional History
(close of fiscal year – June 30, 2025)

\$70M

Increase in Net Assets End of Fiscal Year
(June 30, 2025)

\$685M

Total Net Assets End of Fiscal Year - June 30, 2025
(Buildings, land, cash, investments, etc.)

#1

Ranked Largest Private Institution in INDIANA by Enrollment

\$10M

In Scholarships and Other Programs Funded From the Endowment

IWU BY THE NUMBERS



ON MISSION. IN MOTION.

ENROLLMENT

IWU MARION

2,060 TOTAL UNDERGRADUATE ENROLLMENT, AUGUST 2025

578 INCOMING FRESHMAN, 2025

57 INCOMING TRANSFERS, 2025

635 TOTAL INCOMING STUDENTS, 2025

26 INCOMING GRADUATE STUDENTS, 2025

NATIONAL & GLOBAL

12,146 TOTAL ENROLLMENT, AUGUST 2025

7.9% FY24 TO FY25 YEAR-OVER-YEAR TOTAL ENROLLMENT GROWTH

4.9% FY24 TO FY25 YEAR-OVER-YEAR CORE ENROLLMENT GROWTH

13.2% FY25 AVERAGE NURSING ENROLLMENT, YEAR-OVER-YEAR GROWTH

WESLEY SEMINARY

714 TOTAL ENROLLMENT, AUGUST 2025

34% GROWTH IN ENROLLMENT IN MASTER'S PROGRAMS

9% INCREASE IN NEW STUDENT ENROLLMENT



Economic Impact

ECONOMIC IMPACT IN GRANT COUNTY

Due to IWU's presence, Grant County experiences almost \$231 million in total economic impact, supporting 1,420 jobs with almost \$90 million in employee compensation within the County.

ESTIMATED AGGREGATE ECONOMIC IMPACT TO GRANT COUNTY, BY IMPACT CATEGORY

Economic Impact	Operations	Capital	Ancillary Spending	Wage Premium	Total
Total Output	\$158.3M	\$25.6M	\$20.3M	\$26.3M	\$230.5M
Total Employment (FTE)	860	180	230	150	1,420
Employee Compensation	\$71.3M	\$7.9M	\$3.0M	\$7.5M	\$89.7M

DID YOU KNOW?
IWU is one of the largest employers in Grant County

INDIANA WESLEYAN UNIVERSITY GENERATES OUTSIZED IMPACTS IN THE STATE OF INDIANA

STATEWIDE
PROCUREMENT

\$12M
ANNUALLY

ANNUALIZED ECONOMIC IMPACT BY GEOGRAPHY

STATE OF INDIANA	\$649M TOTAL	3,510 JOBS	\$215M EARNINGS
GRANT COUNTY	\$231M TOTAL	1,420 JOBS	\$90M EARNINGS
MARION COUNTY	\$117M TOTAL	520 JOBS	\$39M EARNINGS

TAX REVENUE
GENERATED FOR THE
STATE OF INDIANA

\$18.6M
ANNUALLY

2:1 STATEWIDE RETURN
ON INVESTMENT
ROI

For every \$1 Indiana invests in IWU, the State receives nearly two dollars back in fiscal revenue, demonstrating the University's exceptional value as a catalyst for economic growth and tax base expansion throughout Indiana.



ON MISSION, IN MOTION is not simply a theme for this report it's our approach to reach our vision, to make Indiana Wesleyan University the Christ-centered university of choice for every generation. This year has been marked by God's favor through new academic pathways that open doors for students, research that inspires worship and discovery, ministries that reach across the globe, and economic impact that strengthens our economy while supporting thousands of families.

Yet our story is not ultimately about numbers; it is about Christ's impact on lives. Every changed life on our traditional and online campuses testifies to His redeeming work. Students are being called to Christ, faculty and staff are pouring out their lives in service, and alumni are shaping communities with Kingdom character. At IWU, impact is found in prayers whispered in residence halls, adult learners returning to school to complete their education, children flourishing because parents found childcare, pastors equipped to lead with courage, and first-generation graduates crossing the stage in tears.

My prayer is that every part of this university will glorify Jesus Christ, and I invite you to join us in that prayer. Ask God to keep IWU faithful, bold and tenderhearted. If He leads you, please partner with us in generosity so more students may be formed here and sent into the world as Christ-centered world changers.



Our mission is not measured in numbers alone but in lives transformed by Christ and sent into the world to serve.

JON S. KULAGA
IWU President



WAYS TO PRAY FOR IWU

- #1** **Pray for IWU to stay mission-focused on providing a Christ-centered holistic education.**
"Therefore, my dear brothers and sisters, stand firm. Let nothing move you."
1 Corinthians 15:58a
- #2** **Pray for our students — that they would know and experience spiritual, emotional and physical wholeness while attending IWU.**
"May your whole spirit, soul, and body be kept blameless at the coming of our Lord Jesus Christ."
1 Thessalonians 5:23b
- #3** **Pray for our students — that they would discover their mission for the Kingdom, whether it be in the secular marketplace of ideas, or full-time ministry.**
"Therefore, my brothers and sisters, make every effort to confirm your calling and election. For if you do these things, you will never stumble."
2 Peter 1:10
- #4** **Pray for our faculty/staff/administration — that they would know and experience a deep inner strength and wisdom as they reach and mentor our students.**
"He is the one we proclaim, admonishing and teaching everyone with all wisdom, so that we may present everyone fully mature in Christ."
Colossians 1:28
- #5** **Pray for our board of trustees — as servant leaders — that they would know and experience a very real sense of God's leading toward the future direction of IWU.**
"He guides me along the right paths for his name's sake."
Psalms 23:3b
- #6** **Pray that God would continue to connect IWU to people, foundations and entities that can be a generous source of support for all our initiatives.**
"And my God will meet all your needs according to the riches of his glory in Christ Jesus."
Philippians 4:19
- #7** **Pray that God will continue to speak to the hearts of our legislators, political leaders and judges to make decisions that do not threaten our religious freedoms and liberties as Christians and as a Christian institution.**
"Again, truly I tell you that if two of you on earth agree about anything they ask for, it will be done for them by my Father in heaven."
Matthew 18:19
- #8** **Pray for revival to sweep our country**
"Will you not revive us again, that your people may rejoice in you?"
Psalms 85:6



4201 S. WASHINGTON ST. MARION, IN 46953 INDWES.EDU